

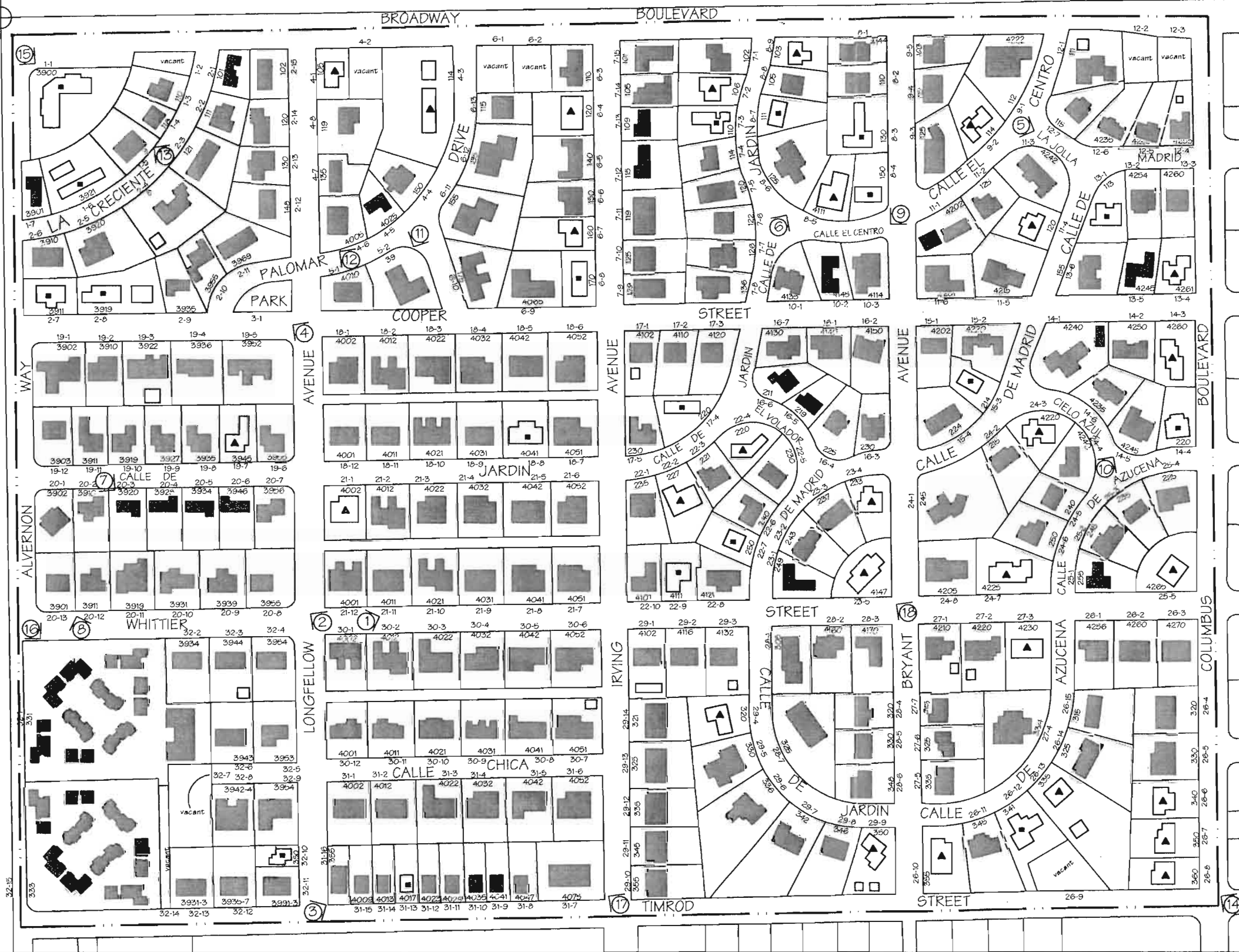





# Historic Resource Survey Through 1960 of the **SAN CLEMENTE NEIGHBORHOOD**

10 June 2004

Tucson Arizona

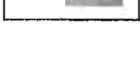
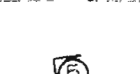

- 2501** Street Address
- 29-17** Inventory Number
-  Individually Eligible Property
-  Contributing Property to a Potential Historic District
-  Non-Eligible Property due to Age
-  Non-Eligible Property due to Integrity
-  Non-evaluated/un-identified structure (not counted in inventory)
-  Proposed District Boundary
-  Photo Key

