

## How do I get Gray Water?

It is up to the homeowner to install a disposal system and reuse gray water on outdoor plants.

People who own new or existing homes may install gray water disposal systems as long as City of Tucson and Arizona Department of Environmental Quality (ADEQ) rules are followed. The stub-out (gray water discharge pipe) may not be visible.

For more information and to register for workshops, contact



**Tucson Water**  
P.O. Box 27210  
Tucson, AZ 85726-7210  
Phone: (520) 791-4331  
[tucsonaz.gov/water/graywater](http://tucsonaz.gov/water/graywater)



**SmartScape**  
4210 N. Campbell Avenue  
Tucson, AZ 85719-1109  
Phone: (520) 626-5161  
Fax: (520) 626-5849

For information on a permit to connect your gray water system, contact



**City of Tucson**  
Planning and Development Services  
201 N Stone Avenue  
Tucson, AZ 85701  
Phone: (520) 791-5550  
[tucsonaz.gov/dsd](http://tucsonaz.gov/dsd)



**City of Tucson Office of Conservation and Sustainable Development**  
201 N Stone Ave ~ Tucson, AZ 85726  
Phone: (520) 791-4675  
[tucsonaz.gov/ocsd](http://tucsonaz.gov/ocsd)

For backflow questions, contact  
Tucson Water at (520) 791-2650.

USE YOUR **GRAY**  
RESIDENTIAL  
**WATER!**  
*— It's Easy! —*



## What is Gray Water?

Gray water is the water that flows from the drains of

- Hand-Washing Sinks
- Showers
- Bathtubs
- Clothes Washing Machines

Starting June 1, 2010, all new single family homes and duplexes in the City of Tucson will be plumbed to allow for the use of gray water.

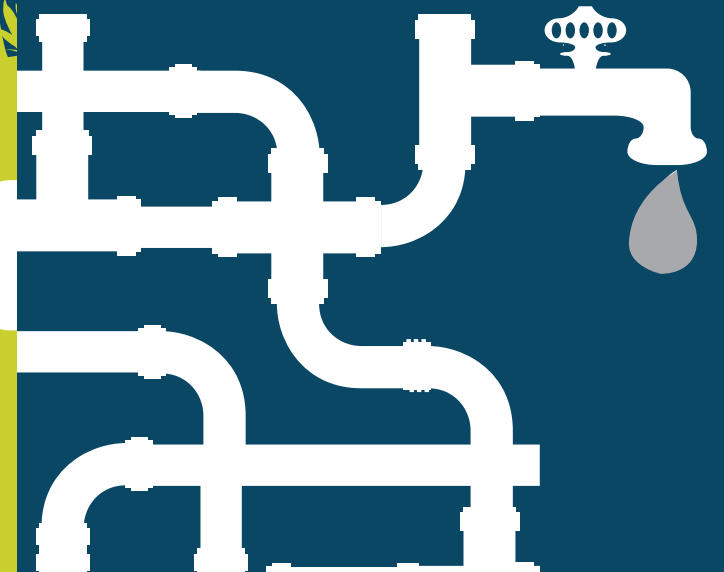



## Why use Gray Water?

- ✓ Save money on your water bill!
- ✓ Reuse gray water for outdoor landscaping to conserve valuable groundwater resources.
- ✓ Reduce potable water use.
- ✓ Recycle household gray water and conserve the amount of water that the City of Tucson will need to pump from the ground or the Colorado River.



## Gray Water tolerant plants:

- ✓ Citrus and nut trees
- ✓ Native trees and shrubs
- ✓ Bermuda grass
- ✓ Oaks, junipers, eucalyptus, fan and date palms
- ✓ Bougainvillea
- ✓ Oleander
- ✓ Other salt tolerant plants



## Do's and Don'ts:

- ✓ Gray water may be used to irrigate by flooding, through underground pipes or a drip system.
- ✓ Do not spray irrigate with gray water.
- ✓ Use a detergent that is low in sodium, phosphate, conductivity and alkalinity. Avoid detergents that contain boron or are high in salts, such as sodium, or phosphates or softening powder. Boron and salt are toxic to plants.
- ✓ Water from softening systems that use sodium chloride should not be used for gray water. The salt from this type of water softening will harm plants. However, potassium chloride water softening systems may be considered.
- ✓ A residential gray water system may not exceed 400 gallons per day. A house would produce that gray water from 15 loads of laundry in a top loading machine, plus four, 20-minute showers plus one hour of hand washing in one day.



## Gray Water friendly detergents:

- |               |  |
|---------------|--|
| ✓ Alfa Kleen  | ✓ Yes  |
| ✓ All Regular | ✓ Other biodegradable low sodium, boron, phosphorus detergents |
| ✓ Bold        |  |
| ✓ ERA Plus    |  |
| ✓ Oasis       |  |
| ✓ Shaklee     |  |

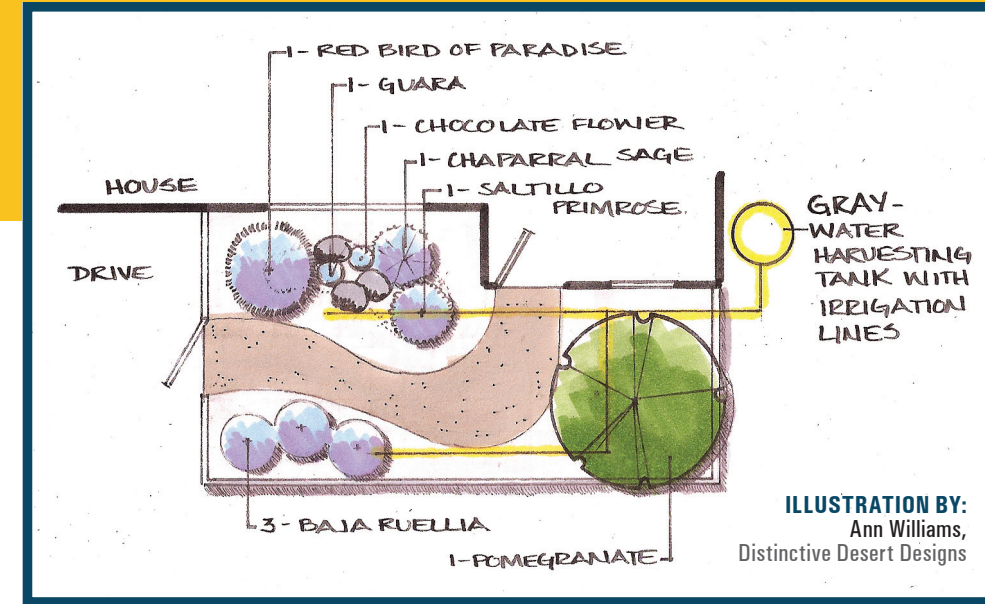

YELLOW BIRD OF PARADISE

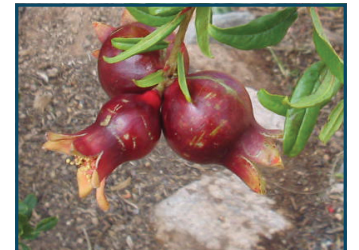

POMEGRANATE



## A summary of the Gray Water rules:

- Water flowing from showers, bathroom sinks, and washing machines may be used for your gray water system.
- Do not use water that flows from your kitchen sink, toilets, or dishwasher. It is not gray water.
- Gray water systems may also be installed in an older single family home or duplex.
- Your gray water must be used on your property. Don't let it run off!
- Gray water may be used for household gardening, composting, lawn watering and landscape watering.
- Surface watering of gray water may not be used to irrigate food plants, except for citrus and nut trees.
- Any gray water holding tank must be sealed, secured and covered.
- Tanks and piping must be clearly labeled with "Danger. Unsafe Water Supply" or other similar language.
- All gray water systems must have an overflow pipe connected to the sewer system or an on-site wastewater disposal system.
- You cannot connect your gray water system to your freshwater system because you may be endangering your drinking water supply.
- If a pump is used to distribute the Gray Water, a reduced pressure backflow assembly needs to be installed on the potable water meter connection to protect the public potable water system.
- You must obtain a permit from the City of Tucson to access your sewer line.