

ARIZONA STATE HISTORIC PROPERTY INVENTORY

PROPERTY NAME

LOCATION

East Fort Lowell Road

CITY/TOWN/VICINITY

Tucson

COUNTY

Pima

OWNER

Kenneth and Annabel Scofield

OWNER'S ADDRESS

5349 East Fort Lowell Road
Tucson Arizona 85712

FORM COMPLETED BY

John S. Jones

ADDRESS

625 N. Norton Ave.
Tucson, Arizona 85719

PHOTO BY

Roz Spicer

DATE

1977

VIEW

Looking east from Dirt Lane

PRESENT USE

Residence

ACREAGE

.93

STYLE OR CULTURAL PERIOD

Sonoran/ Contemporary

SIGNIFICANT DATES

1873/1945/1953/1974

PHYSICAL DESCRIPTION

Materials: adobe/ stucco

Color: tan

Dimensions: 40'x 78'

Plan; Irregular/ one story

Roof: Flat w/ parapets

Exterior: brick trim on parapet

Grounds: large mesquite trees.

East half of lot is vacant.

Small shrine in front of res.

Storage bldg. - wood/ galvanized roof

STATEMENT OF SIGNIFICANCE

This residence has incorporated into it the west wall of the Riallito House. The original adobe wall has been stuccoed. The alternate spacing of adobe blocks for the chicken coop is still visible.

This property lies within the boundaries of Arizona BB:9:14

VERBAL BOUNDARY DESCRIPTION

Parcel Code: 110-09-018A/ 110-09-018B

Legal: W 201.1' of E 923.76' of S 155' of NE 4 NE 4 and W 203.1' pf E 923.76' of N 45' M/L of SE 4 NE 4 Sec 35- 13S - 14E GSRB&M

HD 4-8A

#-235

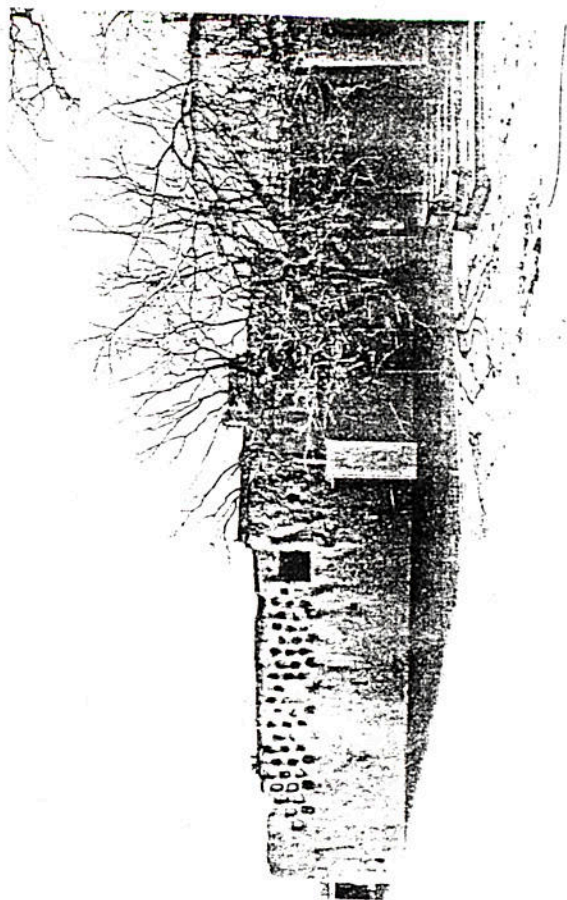

PART OF: Fort Lowell MRA

FINAL
JUNE 2011
FROM SHPO



Hokokami Site
700-1250 A.D.

Gravity Ditches

FT. LOWELL PARK

CRAVORDETT ROAD

FRANCISCO BLVD

100

11A

11B

11C

12

13

14

15

16

17

18

19

20

21

22

23

24

25

26

27

28

29

30

31

32

33

34

35

36

37

38

39

40

41

42

43

44

45

46

47

48

49

50

51

52

53

54

55

56

57

58

59

60

61

62

63

64

65

66

67

68

69

70

71

72

73

74

75

76

77

78

79

80

81

82

83

84

85

86

87

88

89

90

91

92

93

94

95

96

97

98

99

100

101

102

103

104

105

106

107

108

109

110

111

112

113

114

115

116

117

118

119

120

121

122

123

124

125

126

127

128

129

130

131

132

133

134

135

136

137

138

139

140

141

142

143

144

145

146

147

148

149

150

151

152

153

154

155

156

157

158

159

160

161

162

163

164

165

166

167

168

169

170

171

172

173

174

175

176

177

178

179

180

181

182

183

184

185

186

187

188

189

190

191

192

193

194

195

196

197

198

199

200